



Landair
Surveys



Surveying and spatial solutions for

Engineering and construction

From Sydney to Melbourne, Landair Surveys supports civil and construction projects with precise data to guide each phase of **building and compliance** – ensuring alignment with design specifications and helping construction teams deliver on time.

Learn more at landair.com.au/our-solutions/for-engineering-and-construction

Why choose Landair Surveys

We understand the demands of construction sites: high accuracy, problem-solving and fast response times are vital to **keep projects on track**. We:



Are well known among construction managers for our reliability.

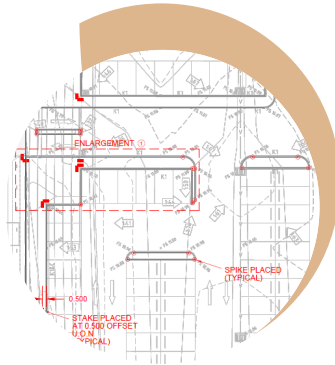

Develop setout plans that support quality assurance and minimise errors.



Understand the need for next-day turnarounds to keep construction moving.



Have team members on-call and ready to respond when you need us most.



Know how costly mistakes can be – we don't crack under pressure.



Often get commissioned to fix problems on existing projects.

How we support **your project**

Landair's years of experience in construction surveying means that your team can always have the data it needs to minimise errors and keep your project moving.

We capture your spatial data using...

- ✓ Setout surveys
- ✓ Control and monitoring surveys
- ✓ Feature and level surveys
- ✓ Underground services surveys
- ✓ Title re-establishment surveys
- ✓ As-built surveys

We deliver actionable data as...

- ✓ On-site survey marks
- ✓ Detailed survey plans
- ✓ Digital data outputs
- ✓ Accessible follow-up expertise



See our success on a project like yours

Project
Customer Fulfilment Centre (Coles)

Client
FDC Construction and Fitout

Completed
November 2023

Location
Truganina, Victoria



Landair Surveys partnered with FDC Construction & Fitout to deliver precision surveying for the **87,000 m²** Coles Customer Fulfilment Centre in Truganina, a state-of-the-art facility designed to transform online grocery shopping in Melbourne. Using advanced robotic technology and AI, the facility processes up to 10,000 orders daily, with 700 robots operating on a raised 3D grid for rapid item collection and packing.

Landair's role **spanned 2,200 hours**, from initial grid-line and hold-down bolt setout to final as-built column checks. The team maintained a robust control network across the multi-level site to meet strict accuracy requirements essential for integrating the robotic systems.

Despite complex logistics and a dynamic work environment, Landair delivered rigorous, detailed reporting that ensured construction precision and set the foundation for the facility's operational success.

See our **engineering and construction clients**

We've delivered vital survey data for **significant engineering and construction clients** – including projects across commercial, industrial and specialised facilities.





Introducing our latest tool for progress tracking – the NavVis VLX3

Time is money for any construction project. Even small delays can compound quickly, affecting schedules, budgets and downstream decision making.

At Landair we use our wearable 3D laser scanner to help construction managers stay ahead of the usual Gantt Chart slip.

As we move through your project, the scanner records everything in its line-of-sight. We are talking about millions and millions of measured points. While we walk the scanner is also taking numerous 360° images to provide a complete snapshot in time.

Imagine being able to virtually walk through any part of site from your office. You can track the progress of trades and anticipate potential pinch points. You can take ad-hoc measurements and confirm asbuilt levels. You can overlay the design floorplan on the 360° imagery. You can tag notes that get sent to the rest of the team.

How it works...

- ✓ Schedule the walkthrough for an RDO or on the weekend
- ✓ Most projects – half day on site for a full virtual capture
- ✓ We process the data and upload to our online hosting site
- ✓ Access the viewer through a secure web-link
- ✓ Take virtual walkthroughs, 3D flythroughs, see how design compares to existing conditions, share issues with the team – all from the comfort of the site office

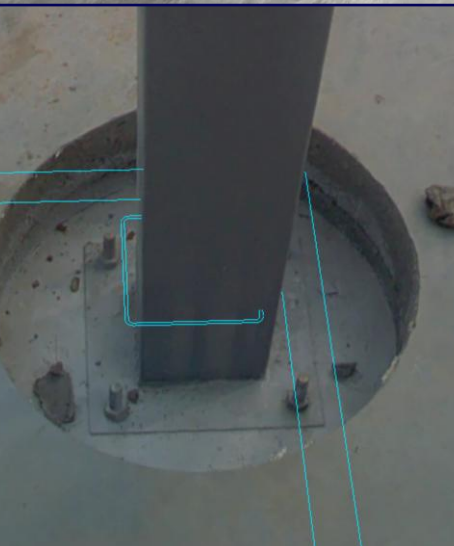

Whether it's rooftop inspections, extracting site contours, earthworks volume calcs or tracking progress with up-to-date aerial imagery **Drone Flyovers** are one way construction managers gain that additional site context

With over a decade of RPA (drone) flying under our belts we stand ready to take to the skies above your project site for a bird's eye view

All our drone pilots are CASA-licensed and fly under our RPA Operator's Certificate (ReOC). We maintain a strong safety culture and proactively engage with all the stakeholders on our projects. Our fleet of mapping and inspection drones are CASA-registered and we even have additional drone-specific Public Liability Insurance

How we help...

- Overlay site orthoimages with design linework for asbuilt checks
- Volume calculations for stockpiles or bulk earthworks
- Hi res rooftop imagery for asset inspection reports
- Mapping flyovers for site contours



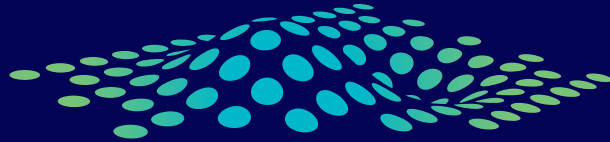

Landair

Surveys

1300 130 158 | info@landair.com.au

landair.com.au



Melbourne (head office)

1/87-91 Heatherdale Road
Ringwood VIC 3134

Sydney

Suite 18, 12 Tryon Road
Lindfield NSW 2070