

Revit Modelling – LOD300

Inclusions (based on survey pickup)

- Walls
- Doors
- Windows
- Beams / trusses
- Steel structures
- Stairs and railings
- Fixed furniture (basic outlines)
- Fixed mechanical equipment
- Floors
- Ceilings
- Roof profile
- Columns
- Concrete elements
- Plumbing fixtures (generic)
- Fences / barriers (basic outlines)
- Major exposed rigid pipes (>50mm)

Exclusions

- Nuts & bolts
- Flexible / non-rigid piping
- Conduits & Ducting
- Ceiling objects
- Wall fixtures
- Electrical equipment
- Loose items
- Electrical wires / cable trays
- Services cupboard pipes
- Lighting fixtures
- Switches / power-points
- Drainage elements

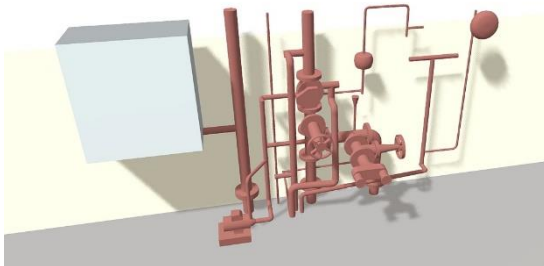

Revit Modelling – LOD400

Inclusions (based on survey pickup)

- Walls & wall fixtures
- Doors
- Windows
- Beams / trusses / columns
- Steel structures
- Plumbing fixtures
- Fixed furniture (by type)
- Fixed mechanical equipment
- Visible switches / power-points
- Electrical equipment / fixtures
- Floors (by type)
- Ceilings & ceiling objects
- Roof profile
- Concrete elements
- Stairs and railings
- Drainage elements
- Fences / barriers (by type)
- Rigid pipes and connections
- Lighting fixtures
- Cable trays & rigid ducting

Exclusions

- Nuts & bolts
- Flexible / non-rigid piping
- Conduits
- Loose items
- Individual electrical wires
- Flexible ducting

